

Key	
	Proposed Kerbs
	Proposed Signs
	Existing Signs
	Proposed road markings
	Proposed carriageway
	Proposed Footway

New steel Entrance Gates with a height restriction facility at 2m high

REV	DATE	BY	CHK	AMENDMENT
1	09/05/18	HK	GP	Sign and markings amendments
2	10/05/18	HK	GP	Centre bollards removal
-	--/--	-	-	-
-	--/--	-	-	-

NOTES

H:\Traffic\AA_PROJECT SUPPORT\Lighthorne\No Right Turn TRO Avon Valley Bowls Club\1 drawings\1935-P-07C_08B_09A Proposed Site Plan.dwg

Based on Ordnance Survey mapping with the permission of the Controller of HMSO
 © Crown Copyright and database right 2011. Ordnance Survey 100019520.
 All rights reserved.
 Unauthorised reproduction infringes copyright and may lead to prosecution or civil proceedings.
 Warwickshire County Council.

REV	DATE	BY	CHK	AMENDMENT
1	09/05/18	HK	GP	Sign and markings amendments
2	10/05/18	HK	GP	Centre bollards removal
-	--/--	-	-	-
-	--/--	-	-	-

Drawing title	Proposed No Right Turn TRO Avon Valley Bowls Club New Access B4100 Wade Lane	
Project title		Avon Valley Bowls Club Access

Drawn by	HK	Checked by	GP
Date	Feb 2018		
Scale	NTS @ A3_L		
Drawing number	TR10680		

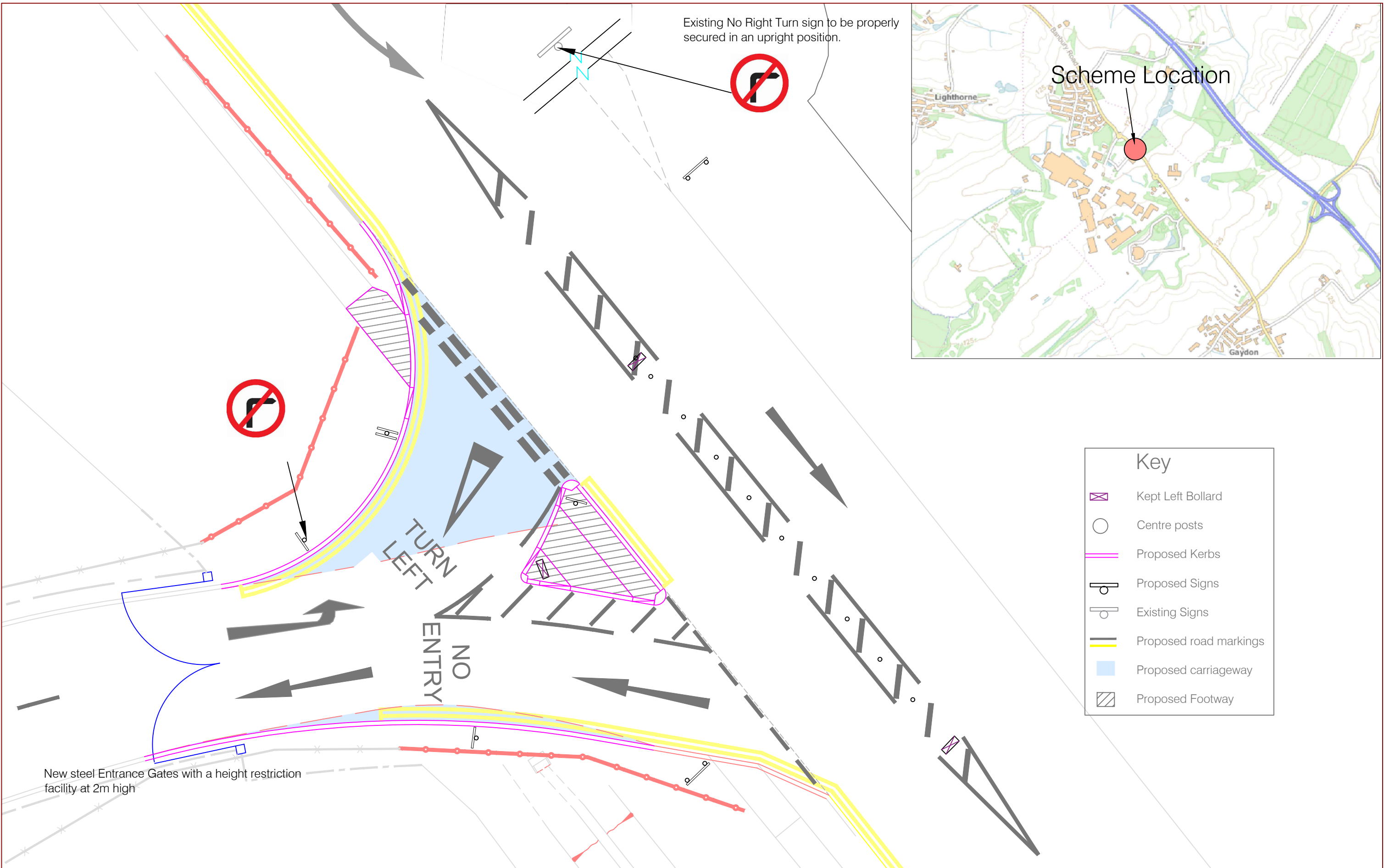

Key	
	Kept Left Bollard
	Centre posts
	Proposed Kerbs
	Proposed Signs
	Existing Signs
	Proposed road markings
	Proposed carriageway
	Proposed Footway

New steel Entrance Gates with a height restriction facility at 2m high

NOTES

H:\Traffic\AA_PROJECT SUPPORT\Lighthorne\No Right Turn TRO Avon Valley Bowls Club\1 drawings\1935-P-07C_08B_09A Proposed Site Plan.dwg
 Based on Ordnance Survey mapping with the permission of the Controller of HMSO
 © Crown Copyright and database right 2011. Ordnance Survey 100019520.
 All rights reserved.
 Unauthorised reproduction infringes copyright and may lead to prosecution or civil proceedings.
 Warwickshire County Council.

REV	DATE	BY	CHK	AMENDMENT
-	--/--	-	-	-
-	--/--	-	-	-
-	--/--	-	-	-
-	--/--	-	-	-

Drawing title	Proposed No Right Turn TRO Avon Valley Bowls Club New Access B4100 Wade Lane
Project title	
Avon Valley Bowls Club Access	

Drawn by	HK	Checked by	GP
Date	Feb 2018		
Scale	NTS @ A3_L		
Drawing number	TR10680		

Warwickshire County Council
TRANSPORT AND ECONOMY

Traffic & Road Safety
 Communities
 Shire Hall Post Room
 Warwick, CV34 4SP
 Tel : 01926 410410

www.warwickshire.gov.uk
<mailto:communities@warwickshire.gov.uk>

Avon Valley Bowls Club, New Access, B4100 Wade Lane, Lighthorne

Prohibition of Right Turn movement

1. STATEMENT OF REASONS

- 1.1** Warwickshire County Council in exercise of their powers under the Traffic Regulation Act 1984, propose to introduce a permanent Traffic Regulation Order, the effect of which will be to prohibit vehicles travelling southbound on B4100 Wade Lane from turning right into Avon Valley Bowls Club and prohibit also to vehicles exiting the Avon Valley Bowls Club from turning right onto the B4100 Wade Lane.
- 1.2** The proposed new access along the B4100 Wade Lane, Lighthorne approved by Warwickshire County Council will be used for Avon Valley Bowls Club. Presently, a temporary access is provided for the Severn Trent works, which is proposed to convert into a priority junction to provide an access to Avon Valley Bowls Club.
- 1.3** A detailed transport assessment has been undertaken and, in the interests of highway safety, the access junction to Avon Valley Bowls Club will operate only as a left turn in from Wade Lane and a left turn out onto Wade Lane.

2. SCHEDULE

- 2.1** For clarity and avoidance of confusion, it should be read in conjunction with Plan No. TR10680 (Rev 2) Proposed No Right Turn TRO.
- 2.2** List of the prohibition of Right turns:
 - Vehicles exiting the Avon Valley Bowls Club from turning right onto B4100 Wade Lane.
 - The southbound vehicles on B4100 Wade Lane from turning right into the Avon Valley Bowls Club.

3. EXISTING ORDERS TO BE AMENDED

None